

TOTAL EXTENT (AS PER DOCUMENT) = 2226 Sq.M ✓
 ROAD AREA = 322 Sq.M ✓
 TOTAL NO. OF PLOTS = 17 Nos. ✓

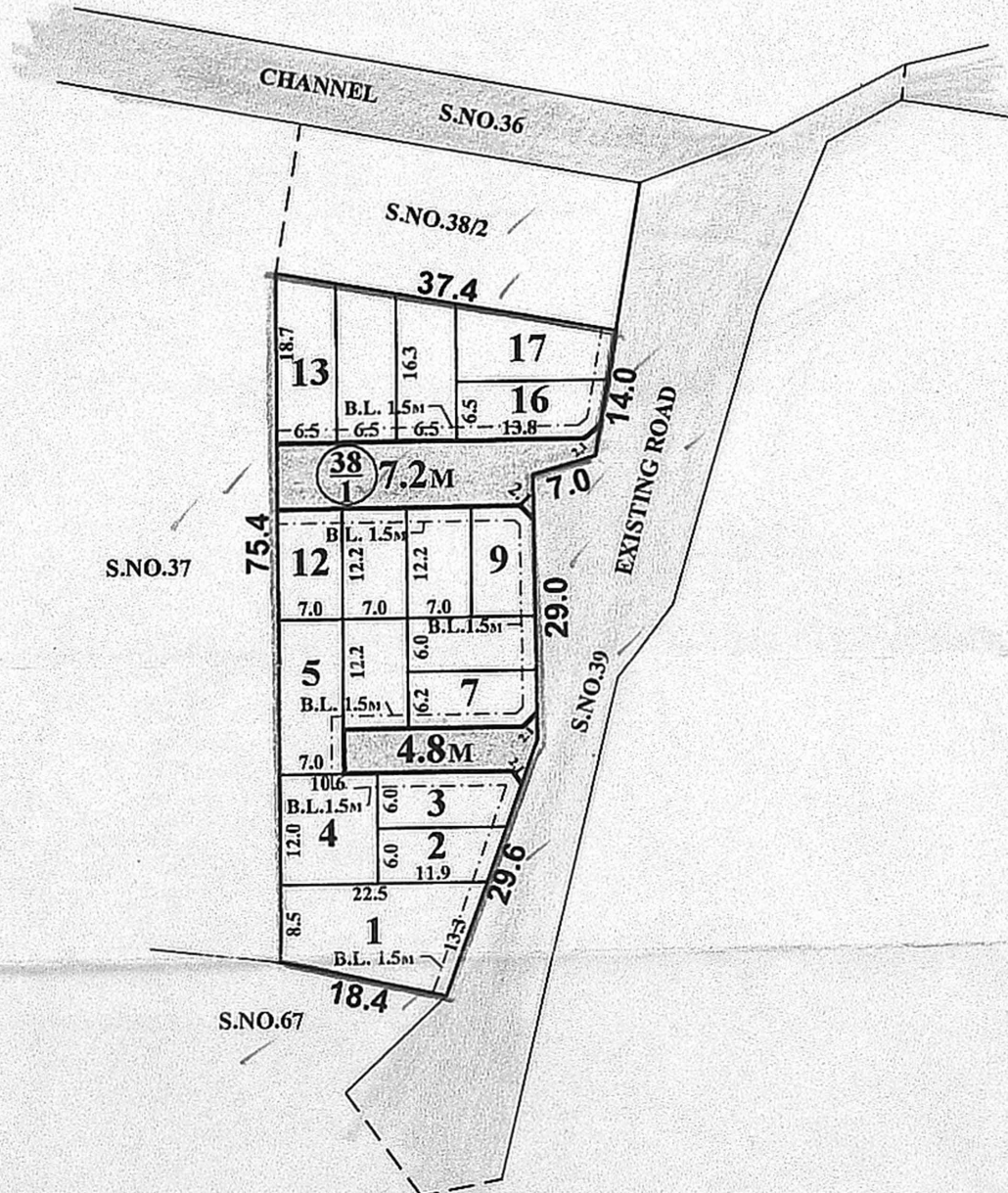

NOTE:

1. SPLAY - 1.5M x 1.5M
2. MEASUREMENTS ARE INDICATED EXCLUDING SPLAY DIMENSIONS
3. ROAD AREA WAS HANDED OVER TO THE LOCAL BODY VIDE GIFT DEED DOC. NO:1460/2019, DATED:01.02.2019 @ SRO, KUNDRATHUR

CONDITION

- (I) THE CHANNEL EXISTS IN S.NO:36 ALONG THE NORTHERN SIDE OF THE SITE, LOCAL BODY ARE REQUESTED TO ENSURE THAT THE REMARKS FROM PWD ON INUNDATION ASPECTS TO BE OBTAINED BEFORE RELEASE OF FINAL APPROVED LAYOUT. ✓
- (II) **DR RULE No: 29 (11):**
 THE COST OF LAYING IMPROVEMENTS TO THE SYSTEMS INRESPECT OF ROAD, WATER SUPPLY, SEWERAGE, DRAINAGE OR ELECTRIC POWER SUPPLY THAT MAY BE REQUIRED AS ASSESSED BY THE COMPETENT AUTHORITY, SHALL BE BORNE BY THE APPLICANT. ✓

LEGEND:

- ▬ SITE BOUNDARY ✓
- ▬ ROADS GIFTED TO THE LOCAL BODY ✓
- ▬ EXISTING ROAD ✓
- ▬ CHANNEL ✓

CONDITIONS:

THE LAYOUT APPROVED IS VALID SUBJECT TO OBTAINING SANCTION FROM THE LOCAL BODY CONCERNED.

P.P.D NO: 28
 L.O 2019

APPROVED

VIDE LETTER NO : L1 / 19756 / 2018 ✓
 DATE : 07/03/2019

FOR SENIOR PLANNER
 CHENNAI METROPOLITAN
 DEVELOPMENT AUTHORITY

PREPARED BY P.A-IV (S.M)

CHECKED BY P.A.II (N.B.V)

A.P.(S.A)

KUNDRATHUR PANCHAYAT UNION
LAYOUT OF HOUSE SITES IN S.Nos: 38/1 OF PARANIPUTHUR VILLAGE.

SCALE : 1:800 (ALL MEASUREMENTS ARE IN METRE.)

